

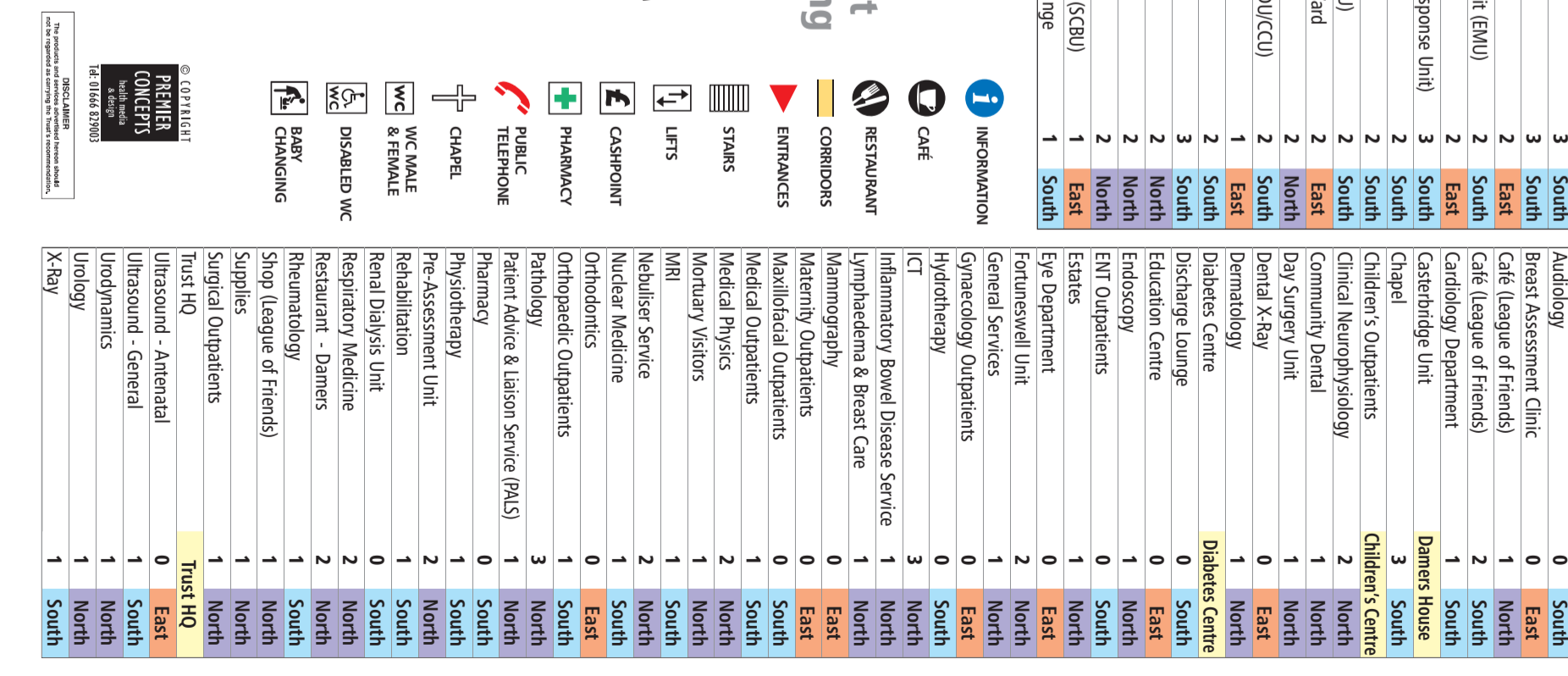

# Welcome to Dorset County Hospital NHS

NHS Foundation Trust

To locate a ward or department look it up on this alphabetical list to find the correct Level and Wing, then look at the appropriate Level map to see how to get there. Make your way to the correct Wing before using the stairs or lift to reach the right Level.

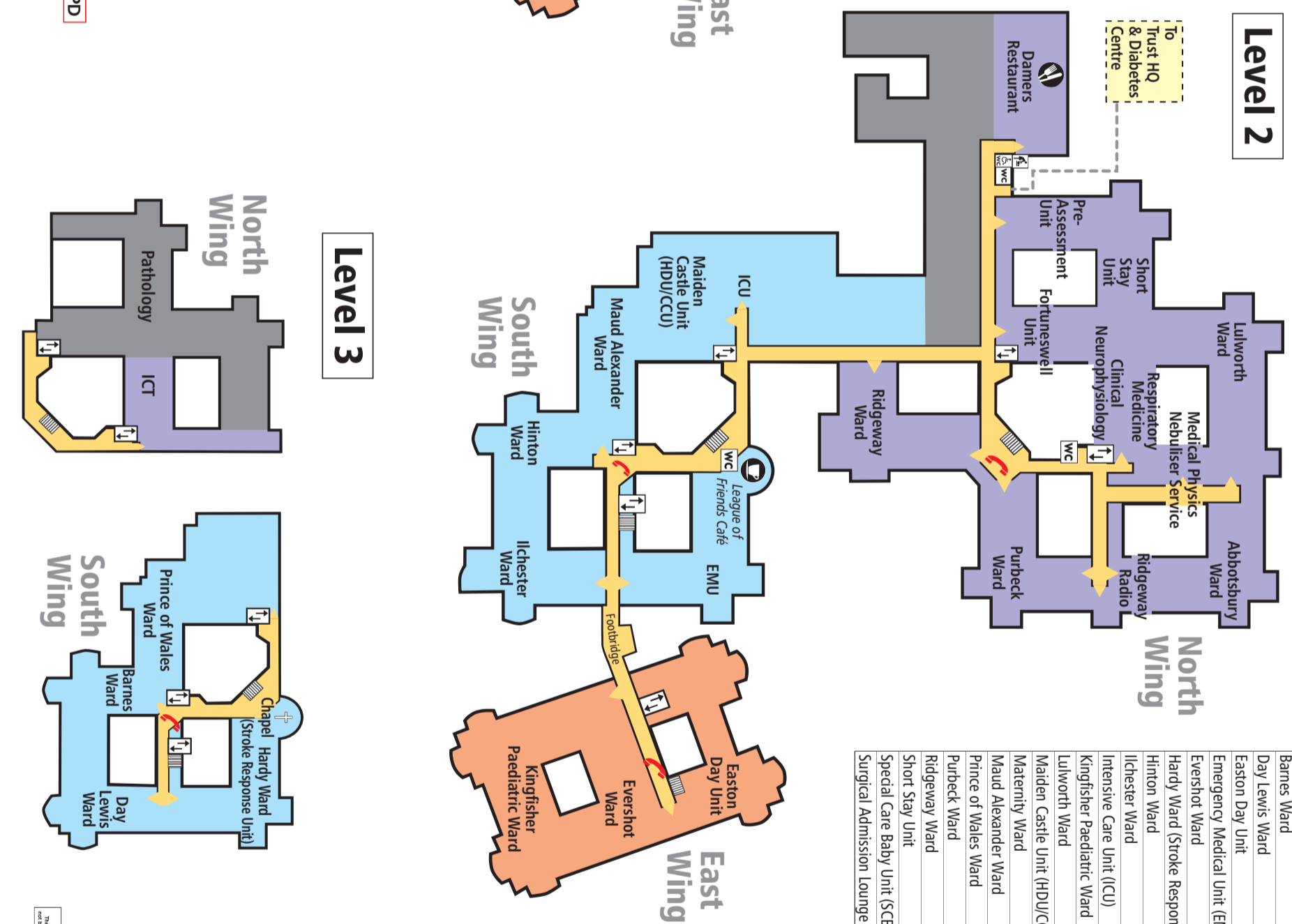
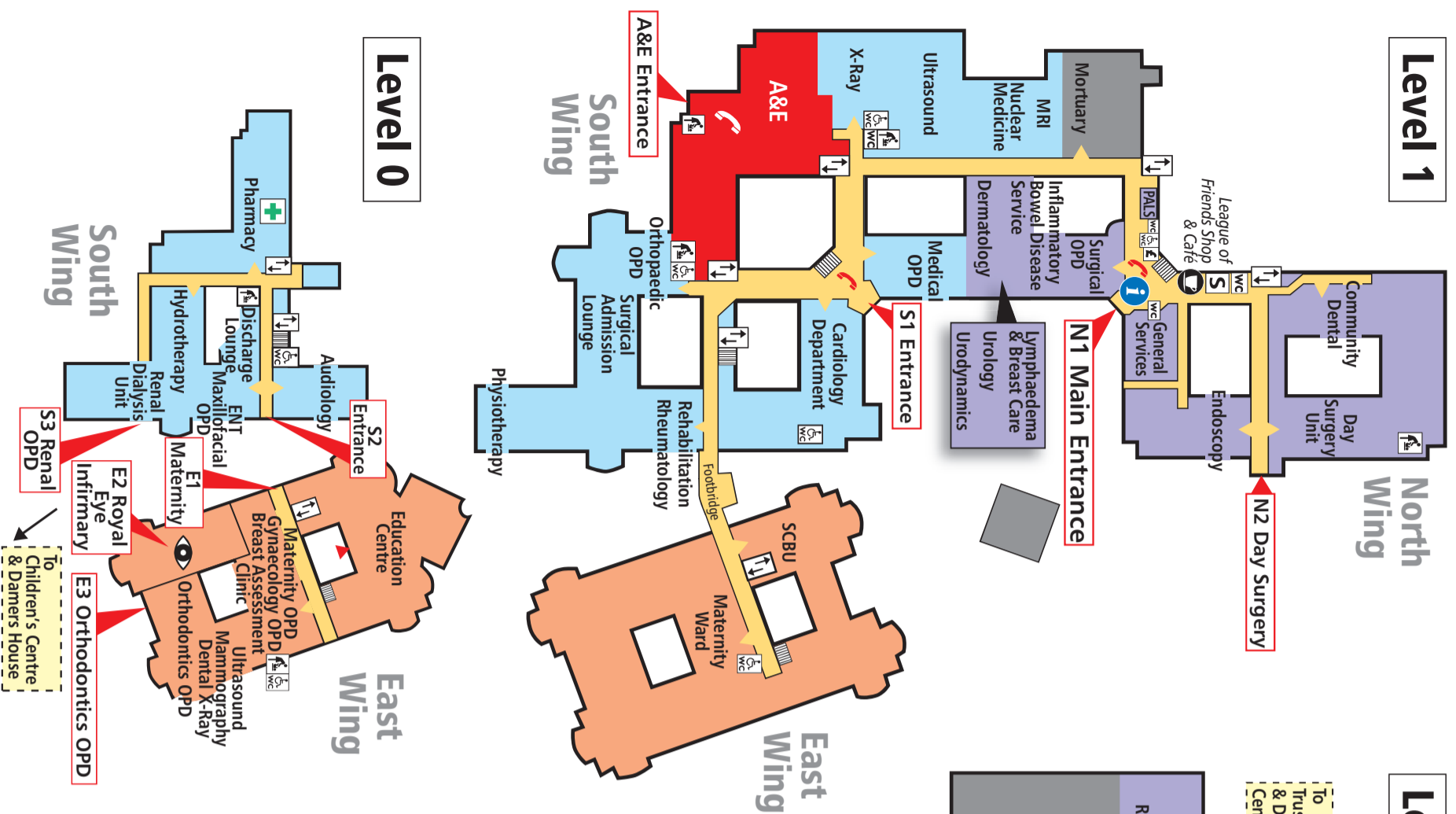

Ward	Level	Wing	Department	Level	Wing
Abbotsbury Ward	2	North	Accident & Emergency (A&E)	1	South
Barnes Ward	3	South	Audiology	0	South
Day Lewis Ward	3	South	Breast Assessment Clinic	0	East
Eastern Day Unit	2	East	Café (League of Friends)	1	North
Emergency Medical Unit (EMU)	2	South	Café (League of Friends)	2	South
Evershot Ward	2	East	Cardiology Department	2	South
Hardy Ward (Stroke Response Unit)	3	South	Cardiology Department	1	South
Hinton Ward	2	South	Casterbridge Unit	1	South
Ilchester Ward	2	South	Chapel	3	South
Intensive Care Unit (ICU)	2	South	Children's Outpatients	3	South
Kingfisher Paediatric Ward	2	East	Clinical Neurophysiology	2	North
Lulworth Ward	2	North	Community Dental	1	North
Maiden Castle Unit (HDU/CCU)	2	South	Day Surgery Unit	1	North
Maternity Ward	1	East	Dental X-Ray	0	East
Maud Alexander Ward	2	South	Dermatology	1	North
Prince of Wales Ward	3	South	Diabetes Centre	1	North
Purbeck Ward	2	North	Diabetes Centre	0	South
Ridge Way Ward	2	North	Discharge Lounge	0	East
Short Stay Unit	2	North	Education Centre	0	South
Special Care Baby Unit (SCBU)	1	East	Endoscopy	1	North
Surgical Admission Lounge	1	South	ENT Outpatients	0	South
			Estates	1	North
			Eye Department	1	North
			Fortuneswell Unit	0	East
			General Services	2	North
			Gynaecology Outpatients	1	North
			Hydrotherapy	0	East
			ICT	0	South
			Inflammatory Bowel Disease Service	3	North
			Lymphoedema & Breast Care	1	North
			Mammography	1	North
			Maternity Outpatients	0	East
			Maxillofacial Outpatients	0	East
			Medical Outpatients	0	South
			Medical Outpatients	1	South
			Medical Physics	2	North
			Mortuary Visitors	1	North
			MRI	1	North
			Nebuliser Service	1	South
			Nuclear Medicine	2	North
			Orthodontics	1	South
			Orthodontics	0	East
			Orthopaedic Outpatients	1	South
			Pathology	3	North
			Patient Advice & Liaison Service (PALS)	1	North
			Pharmacy	1	South
			Physiotherapy	0	South
			Pre-Assessment Unit	1	South
			Rehabilitation	2	North
			Renal Dialysis Unit	1	South
			Respiratory Medicine	0	South
			Restaurant - Dammers	2	North
			Rheumatology	1	North
			Shop (League of Friends)	1	South
			Supplies	1	North
			Surgical Outpatients	1	North
			Trust HQ	1	North
			Trust HQ	0	Trust HQ
			Ultrasound - Antenatal	0	East
			Ultrasound - General	1	South
			Uroynamics	1	North
			Urology	1	North
			X-Ray	1	South

- INFORMATION
- CAFÉ
- RESTAURANT
- CORRIDORS
- ENTRANCES
- STAIRS
- LIFTS
- CASHPOINT
- PHARMACY
- PUBLIC TELEPHONE
- CHAPEL
- WC MALE & FEMALE
- DISABLED WC
- BABY CHANGING

© COPYRIGHT  
PREMIER  
CONCEPTS  
Health Media  
& Design  
Tel: 01666 82903

© NHS FOUNDATION TRUST  
All rights reserved. No part of this publication may be reproduced without the prior written permission of the NHS Foundation Trust.