

BRIDPORT ROAD

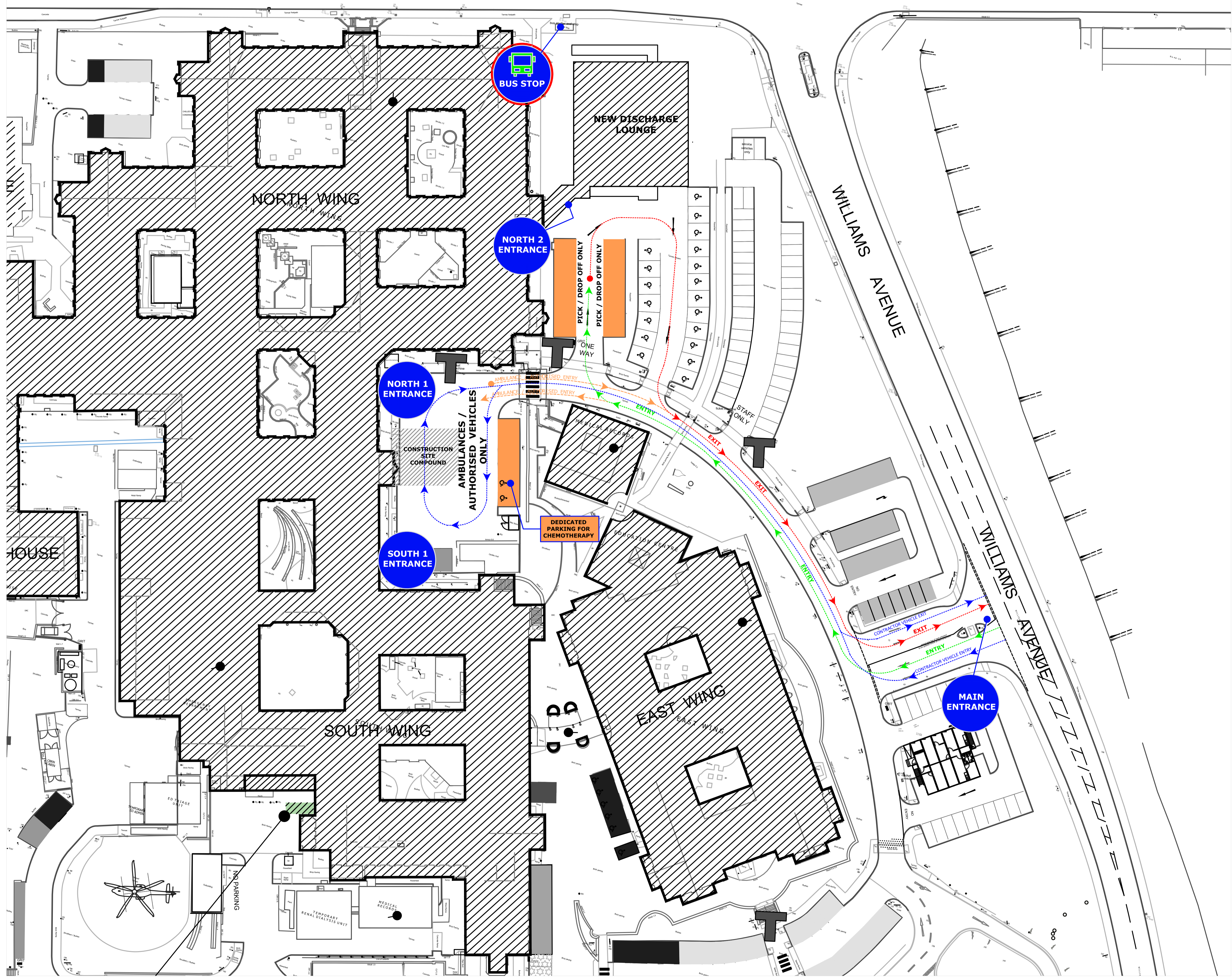

GENERAL NOTES:  
 1. THIS DRAWING IS THE COPYRIGHT OF DORSET COUNTY HOSPITAL NHS FOUNDATION TRUST AND MUST NOT BE RETAINED, COPIED OR USED WITHOUT ESTATES (CAPITAL PROJECTS) DEPARTMENT AUTHORITY.  
 2. ALL DIMENSIONS ARE IN MILLIMETERS OR METERS AND LEVELS IN METERS, UNLESS NOTED OTHERWISE. ALL DIMENSIONS TO BE VERIFIED ON SITE & APPROVED BY THE ENGINEER.

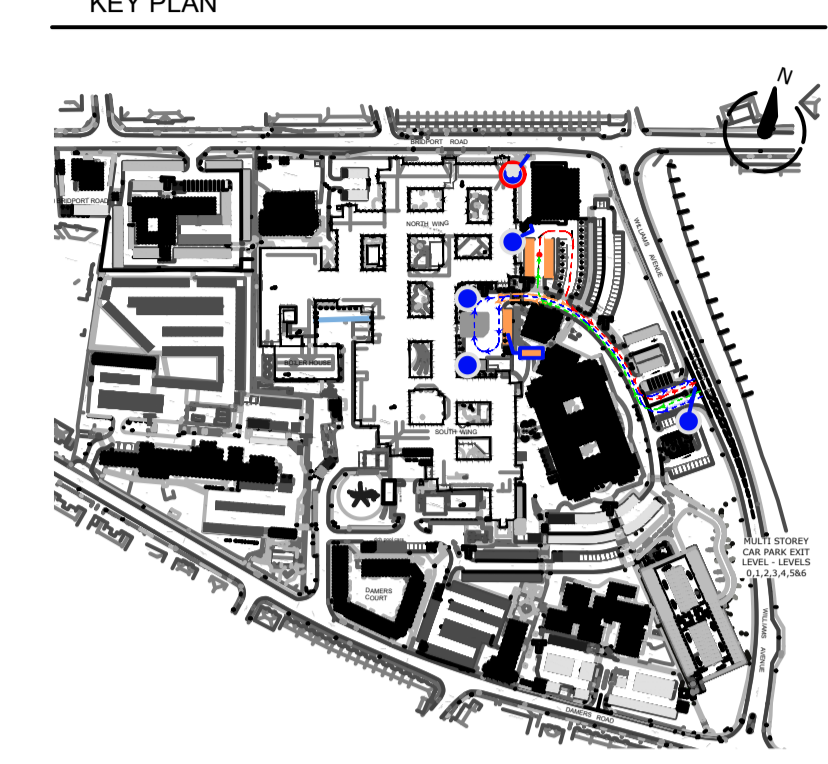

Revision	By	MC	MC	PD	NOV23	ISSUED FOR DISCUSSION
0						

OWNER  
**NHS**  
**Dorset County Hospital**  
 NHS Foundation Trust  
 Williams Avenue, Dorchester, DT1 2JY  
 www.dchft.nhs.uk

ENGINEERING & PROJECT MANAGEMENT  
 DCH  
**Estates**  
 DEPARTMENT  
 Capital Projects, Dorset County Hospital NHSFT  
 Williams Avenue, Dorchester, DT1 2JY  
 www.dchft.nhs.uk

PROJECT  
**DCH PARKING ZONES**

PROJECT CODE  
**TBA**

STAGE  
**PRELIMINARY DESIGN**

DRAWING

**TEMPORARY VEHICLE ACCESS WITH DROP / PICK UP ZONE**

Drawn by	Manu Chacko	Date:	13/11/2023
Checked by	Manu Chacko	Date:	13/11/2023
Authorised by	Paul Daniell	Date:	13/11/2023

DRAWING No.	Revision
<b>A-102</b>	<b>01</b>

Drawing Scale: AS SHOWN Discipline: ARCH  
 CAD filename: Pick up and drop 2023 Plot scale: 1:1 @ A1

SCALE : NA